

# Fixing Toyota's accelerator pedal

Toyota says a simple mechanical fix – fitting a steel reinforcement bar in the accelerator pedal's mechanism – will eliminate excess friction that can cause the accelerator to stick open

**Current pedal:** Problem caused when moisture on interlocking teeth that provide pedal tension generates excessive friction – teeth jam together

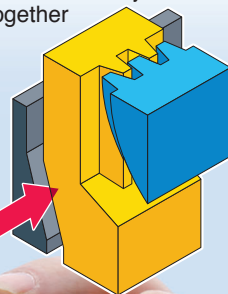
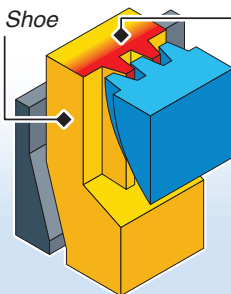

**The fix:** Installing steel shim – few millimetres thick – behind "shoe" will reduce tension and friction

**Do not remove key from ignition, this will lock steering wheel**

Accelerator

## IF YOUR ACCELERATOR PEDAL STICKS:

- Stop normally using brake, but do not pump brake – doing so will deplete vacuum used for power brake assist
- Shift gears into neutral – use brakes to make controlled stop
- If you can't shift into neutral, turn engine off. Toyota says this will not cause loss of steering or braking control