

Two sides to BMW's 3-Series Convertible

The all-new 3-Series Convertible demonstrates its dual personality with the first electronically-operated folding hard-top roof offered by BMW.

Two models are available from launch – the 218hp six-cylinder 325i, and the flagship 335i with its 306hp twin-turbocharged 3.0-litre engine

Folding hard-top roof

Improved security and feeling of light and space for occupants

Rear and side windows: 38% more visibility than earlier BMW convertibles

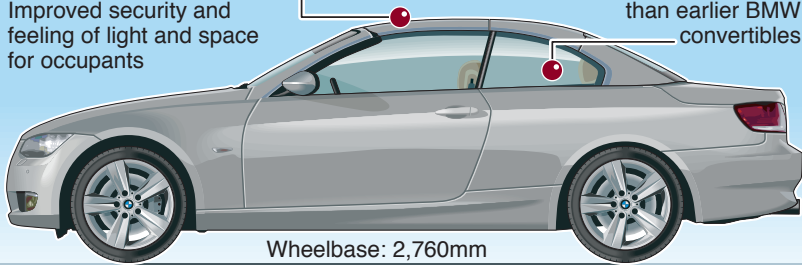

Wheelbase: 2,760mm

Mechanism: Three roof pieces fold away in 22 seconds at push of button in car

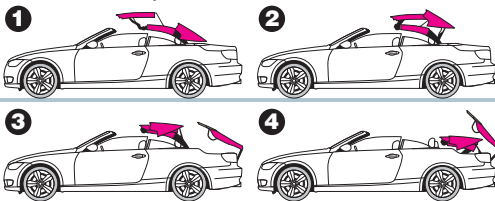

Rear compartment: Stores folded roof

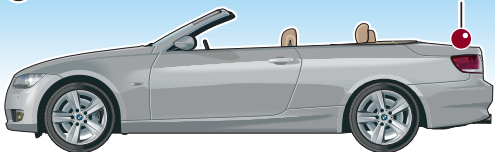

Seating has world's first **SunReflective** leather upholstery – 20% cooler than untreated material

Sources: Neil Winton, BMW

Performance data for 335i

Engine 3.0-litre 6cyl 306hp

Gearbox Six-speed manual

Acceleration 0-100km/h in 5.8 seconds

Top speed 255km/h

Economy 9.9 litres/100km

CO2 emissions 238g/km

Price EUR 55,500

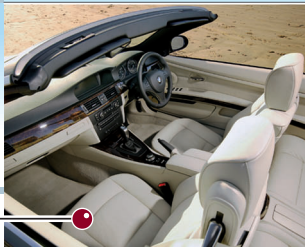

© GRAPHIC NEWS