

How does a photocopier copy?

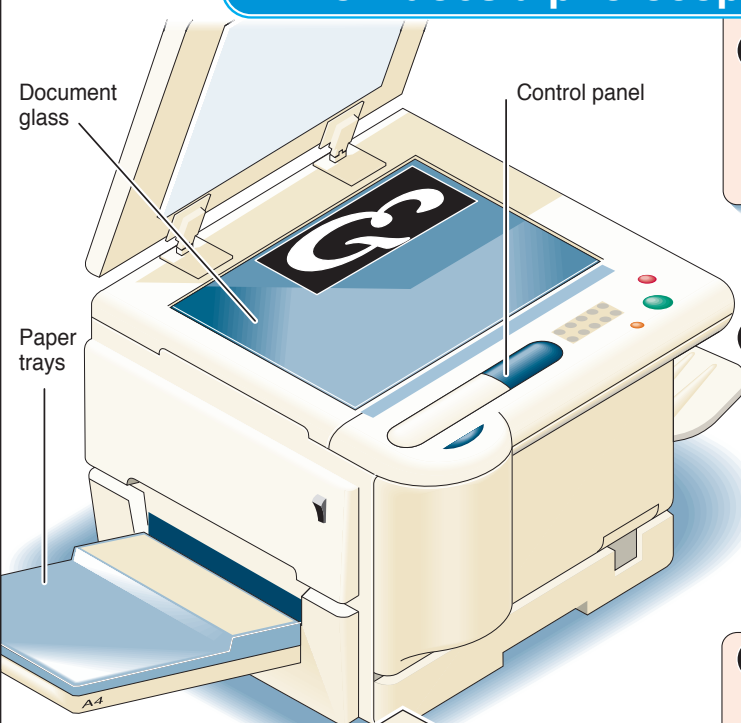

① CHARGE

Electrically charged wire sensitizes drum with electricity

Photo-receptor drum

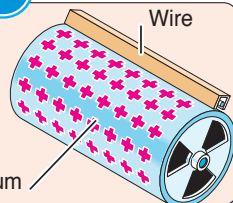

② EXPOSE

Image of document projected on to drum

Light destroys electrostatic charge leaving mirror image still holding positive charge on surface of drum

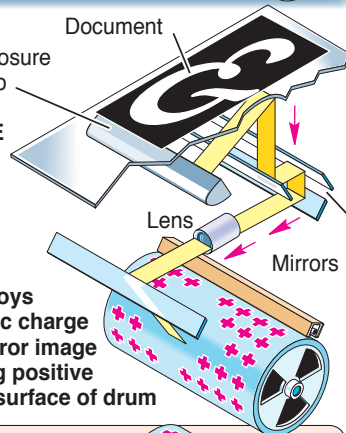

③ DEVELOP

Negatively charged toner powder is dusted over drum. Toner adheres to positively charged image.

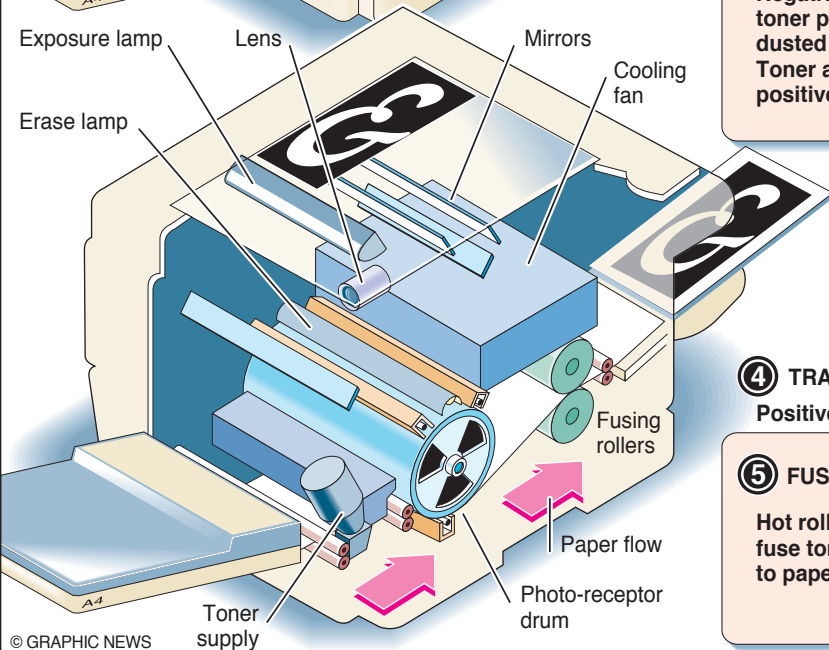
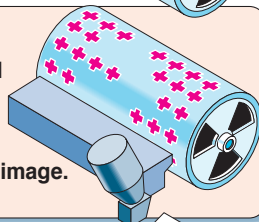

④ TRANSFER

Positive charge below paper attracts toner

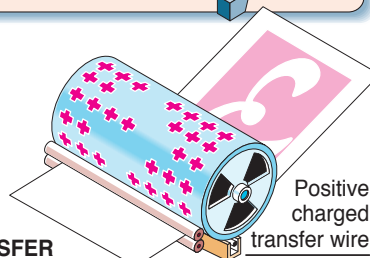

⑤ FUSE

Hot rollers fuse toner to paper

